

NUX 12D DUCTABLE AIR STOVE – TECH. DATA

Wood pellet stove with ductable heat

Option to duct heat into one additional room (8m max.)

Completely sealed stove – ideal for Passive House

Average Thermal Heat Input (Min – Max):	2.45 – 11.75kW
Performance Efficiency (Min – Max):	91.89 – 97.89%
Nominal Overall Power Yield (Min – Max):	2.4 – 10.8kW
Approx. Heating Capacity – Poor Insulation:	50 – 185m ²
Approx. Heating Capacity – Good Insulation:	150 – 555m ²
Pellet Consumption (Min – Max):	0.5 – 2.42kg/hr
Pellet Tank Capacity:	20kg
Approx. burn time (Min – Max):	8 – 39hrs
Flue Outlet Diameter:	80mm
Electrical Requirement (working):	100W
Electrical Requirement (starting):	300W
Net Weight:	110kg
Dimensions (H x W x D):	1,068 x 473 x 537mm



Available in a selection of colours:
bordeaux, white, or black with grey top & door

Stunning aesthetics with coloured, curved glass sides

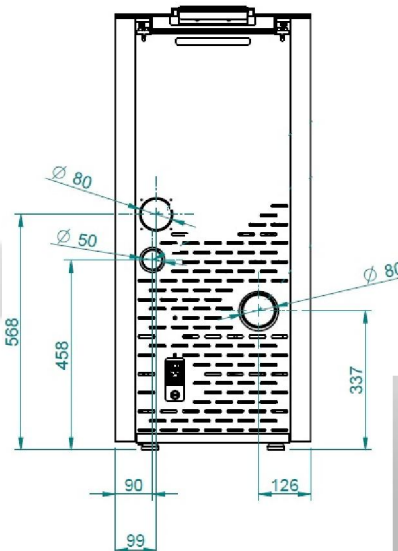

Your trusted local dealer:

